

RADONEYE **PRO**

PROFESSIONAL CONTINUOUS RADON MONITOR

RD200P

NRPP Listed Device # CR-8306

 Wi-Fi Enabled



QUICK START GUIDE

Components



Carrying Bag



RD200P



Tripod Holder



12V Adapter



Extension Cable



Step-up Cable



Battery Pouch

OLED Display



LED

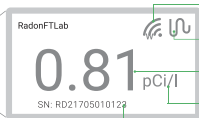

Bluetooth Access Status

Vibration Indicator

Radon Concentration

Units

Other Indicators

If flashing red for 30 sec, radon value exceeds the level you set. If flashing green, Wi-Fi is disconnected or unstable

Tripod Holder

Step-up Cable

Battery in Pouch

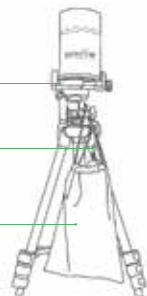

(Up to 72 hours operation with 20Ah/5V)

Showing Battery Power Installation

* Tripod and Battery not included

Sign up and Register Your Device

1. Download the 'RadonEye Pro' app on the Google Play Store or Apple App Store
2. Create a new account with ID & Password
 - ID: Email address*
 - Password must contain at least 8 characters, including a letter of the alphabet and a number.
 - * Email verification needed
3. Select your device
 - The S/N is displayed below the RadonEye Pro
4. Create a name for your device

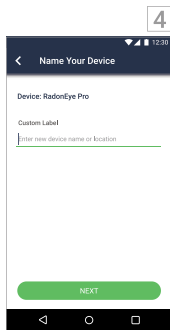
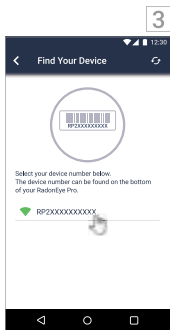
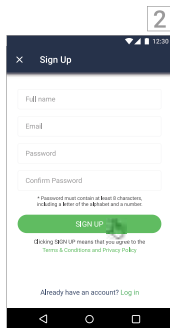

Run an Inspection

1. In the app, tap on the device icon  (or tap 'Device Menu' from the dropdown menu)
2. Tap 'NEW INSPECTION'
 - Up to 10 different inspection results can be saved on one device
3. Set measurement conditions
 - Wait Time: Max 24 hours
 - Inspection Duration: Max 240 hours
 - Display Off: You can hide the displayed radon value
4. If using Wi-Fi, select a Wi-Fi network in the list and enter the Wi-Fi password

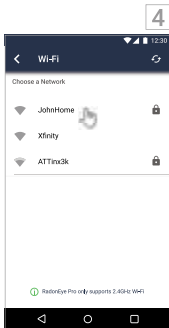
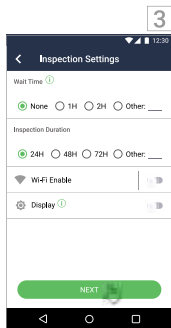
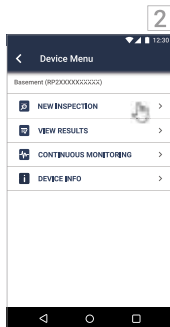
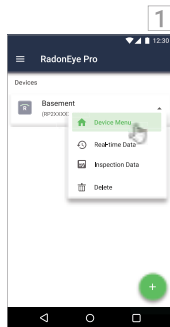

5. Tap the 'START' button

The inspection will begin

6. In 'Settings,' you can select units of measurement for radon and temperature, set an alarm and turn on/off the beep indicator sound

* Alarm: If the measured levels exceed the set value, a red light flashes

* Alarm Interval: The interval at which the red light will flash for the alarm

7. After the inspection is finished, inspection result will be ready by tapping the 'CONFIRM' and device is ready to run another inspection

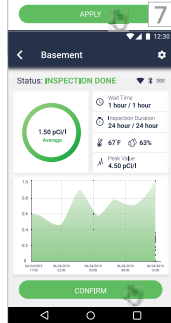
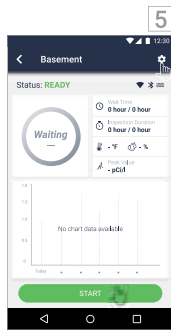

View Results and Share Reports

1. Tap 'VIEW RESULTS'
 - The data files stored in RadonEye Pro are displayed
 - Max 10 files
 - Tap a file to view

2. You can save & share
 - Your data is saved on 'File Load' menu in '.txt' file
 - Data can be sent by email using the 'share' function

3. Tap 'REPORT' to create a report
 - Select/Edit/Add your client name
 - Input notes if necessary
 - Save and share the report as a '.pdf' file

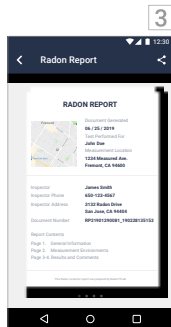
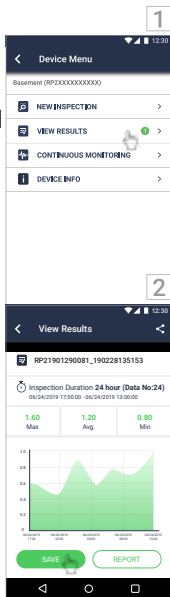

Monitor Radon Continuously

1. Tap 'CONTINUOUS MONITORING'

Select Wi-Fi status

- If Wi-Fi is on, data is automatically uploaded to the server

If Wi-Fi is off, data can be manually uploaded to the server after the

'CONTINUOUS MONITORING'

operation is complete

2. Tap 'START' to begin readings

- Data will be stored on the device for 300 days

If 'CONTINUOUS MONITORING' exceeds 300 days, new data will replace oldest data

3. Name the file and save

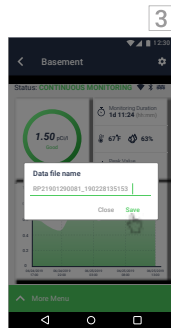
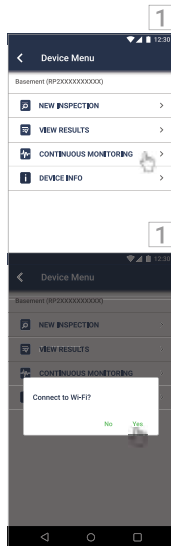
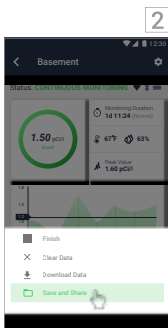

Update Firmware

1. Tap 'DEVICE INFO'

- When new firmware is available, a notification will appear on the DEVICE INFO tab

2. Tap 'UPDATE' and confirm

- RadonEye Pro will be updated to the new version
- Please do not turn off the device while updating

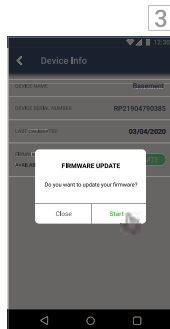
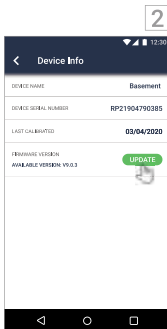
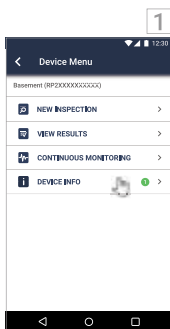

* iOS Firmware update:

- Go to Settings --> Wi-Fi --> Choose a network "RD200P_DFU_MOE"
- > Input password "ftlabftlab" -> Open "RadonEye Pro" App
- > Start firmware update

Manage & Monitor Real Time Radon Online

Visit www.radoneyepro.com

Log in with your ID & PW

On the website, you can access the following:

1. Device Management

- User permissions
- Ownership transfer (if selling the device)
- Device list

2. Client Information

- Client list with name, phone and address

3. Real Time Status Monitoring

- Radon readings updated every 10 minutes

4. Inspection Data

- View the latest data and history by client
- Create reports

5. Reports

* At least 2 years of free cloud management service will be provided with the purchase of a new device

Specifications

Type	Pulsed Ion Chamber
Sensitivity	0.5cpm/pCi/l (30cph/pCi/l)
* MDC	0.18 pCi/l
Range	0.2 ~ 255 pCi/l (9,435 Bq/m ³)
Precision	< 10% at 10pCi/l (after 1 hour)
Accuracy	< ±10% at 10pCi/l (min. error <±0.5pCi/l)
Data storage capacity	Inspection mode : Max 240h x 10 (2,400 data points) Continuous mode : 300 days (7,200 data points)
Data storage Interval	1h (10min update)
Data Communication	Bluetooth LE (Android/iOS), Wi-Fi
Operating Range	34 ~ 104°F (1 ~ 40°C), RH < 80% (No condensation)
Power	DC 12V, 0.1A (12V DC Adaptor)
Size	H4.92(in) x D3.15(in), 8.82(oz) / H125(mm) x D80(mm), 250g
Display	OLED

* Minimum Detectable Concentration

Caution

- Use the 12V DC adapter that comes with this device
- Use the step-up cable (5V to 12V) provided when using the Li-ion battery (>20Ah) as your power source
- Using the device in areas with strong vibration or electromagnetic waves is not recommended
They can affect results
- When internal sensors detect vibration levels that affect readings, the display will indicate the vibration
Inspection data will not be recorded for the duration of strong vibration
- This device is intended for indoor use in an area with humidity of less than 80%
Please do not use in areas with condensation
- The device should be used in temperatures between 34°F and 104°F (1°C ~ 40°C)
- Please follow standard radon measurement protocol

Manufacturer Information

US Office (Sales & Customer support)

Ecosense, Inc.

<http://www.ecosense.io>

Customer support: support@ecosense.io

Manufacturer

FTLab Co., Ltd. (Korea) / <http://www.radonftlab.co.kr>

Calibration service

Bowser-Morner, Inc. (Radon Reference Laboratory)

<http://www.bowser-morner.com/radon-reference-lab>

radon@bowser-morner.com / 937-236-8805 ext. 259